

# SPRINT GT1

1/10 4WD ELECTRIC TOURING

Setup Sheet - Setup Blatt - Feuille de réglage - セットアップシート



December 29th 2002



Phil Channon

Don Valley Stadium

## Front Vorne Avant フロント

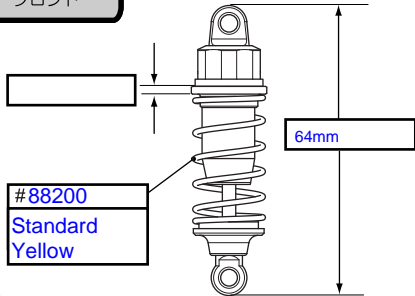

#88200  
Standard  
Yellow

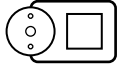
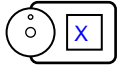

Orion Sledge  
35wt



#3785  
SPRINT 10  
SPOKE 24MM  
WHEEL



#ORI70002  
JB Foam  
Blue 26mm  
Firm



#4435  
B15-40  
Belted  
Racing Slick

-1°

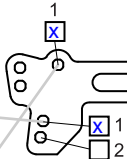
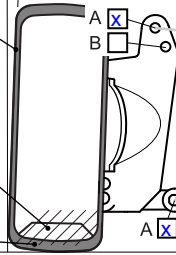

## Rear Hinten Arrière リヤ

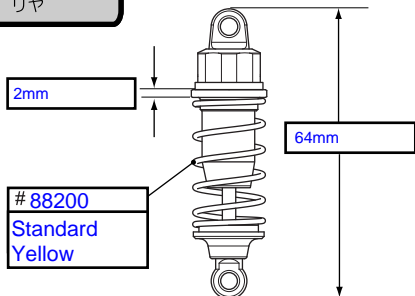

#88200  
Standard  
Yellow

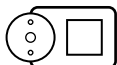
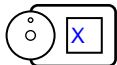

Orion Sledge  
30wt



#3785  
SPRINT 10  
SPOKE 24MM  
WHEEL



#ORI70002  
JB Foam  
Blue 26mm  
Firm



#4435  
B15-40  
Belted  
Racing Slick

-1°

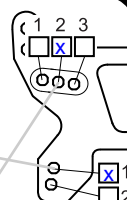
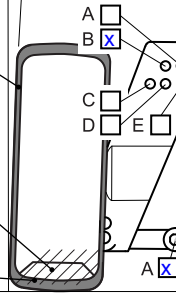

## Top Oben Haut 上

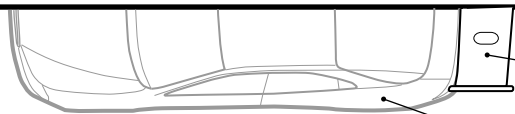

#7250 Citroen Saxo VTS



Futaba S9402



Sanyo 3000HV

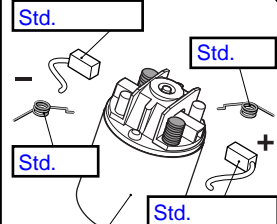
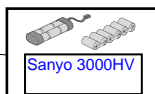

Team Orion  
Core Stock (Dyno-Tuned)  
ORI20021

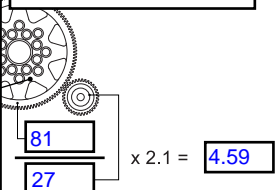

NOSRAM  
Dominator  
Full Power

## Notes ノート

Adjustable top links a must, makes a huge difference to handling, low cost upgrade.

## Run

レース結果

Run/ Qualifier/ Main

Laps

Time

Fastest Lap

Qualified 2nd Stock Class  
Finished 5th

21

5m 12.70

13.32

